

MONITORING PLAN & MAINTENANCE PLAN

ENHANCEMENT PLAN GOALS, OBJECTIVES, AND PERFORMANCE STANDARDS
ENHANCEMENT PLAN GOALS, OBJECTIVES, AND PERFORMANCE STANDARDS ARE OUTLINED IN TABLE 1-1 (BELOW). THE GOALS AND OBJECTIVES OF THIS PLAN ARE CONSIDERED ACHIEVED WHEN THE PERFORMANCE STANDARDS ARE MET.

MONITORING PLAN
AS-BUILT
FOLLOWING COMPLETION OF THE WORK SHOWN ON THIS PLAN, A QUALIFIED PROFESSIONAL SHALL PREPARE AND AS-BUILT OF THE COMPLETED WORK. THE AS-BUILT SHALL BE SUBMITTED TO THE CITY OF MERCER ISLAND FOR REVIEW AND APPROVAL. THE AS-BUILT SHALL BE SUBMITTED TO THE CITY OF MERCER ISLAND WITHIN 30 DAYS OF COMPLETION OF THE WORK. THE AS-BUILT SHALL BE SUBMITTED TO THE CITY OF MERCER ISLAND WITHIN 30 DAYS OF COMPLETION OF THE WORK. THE AS-BUILT SHALL BE SUBMITTED TO THE CITY OF MERCER ISLAND WITHIN 30 DAYS OF COMPLETION OF THE WORK.

MAINTENANCE PLAN
GENERAL MAINTENANCE
GENERAL MAINTENANCE SHALL BE MAINTAINED AT REGULAR INTERVALS DURING THE MONITORING PERIOD TO PROMOTE THE SUCCESSFUL ESTABLISHMENT AND VIGOROUS GROWTH OF THE INSTALLED PLANT STOCK.

TABLE 1-1: GOALS, OBJECTIVES, MONITORING SCHEDULE, & PERFORMANCE STANDARDS

GOAL	OBJECTIVE	SCHEDULE	PERFORMANCE STANDARDS
TO SUCCESSFULLY RE-ESTABLISH WETLAND AND BUFFER AREAS USING NATIVE PLANT SPECIES.	ESTABLISH 60 NATIVE CONIFER TREE SPECIES.	AUGUST OR SEPTEMBER OF YEAR FOLLOWING PLANT INSTALLATION	<ul style="list-style-type: none"> 100% SURVIVAL BY INSTALLED PLANT STOCK AFTER THE FIRST GROWING SEASON (YEAR 1). THIS STANDARD CAN BE MET THROUGH PROPER PLANTING AND MAINTENANCE. 85% SURVIVAL BY INSTALLED PLANT STOCK AFTER THE FIFTH GROWING SEASON (YEAR 5).

GENERAL NOTES:

- WORK SHALL CONFORM TO ANY AND ALL APPLICABLE PERMITS AND/OR APPROVED CONSTRUCTION DRAWINGS.
- WORK SHALL BE COMPLETED BY PERSONS EXPERIENCED IN THE ENHANCEMENT WORK SHOWN ON THESE DRAWINGS.
- BEFORE THE START OF CONSTRUCTION, A PRE-CONSTRUCTION MEETING SHALL BE HELD WITH THE CITY OF MERCER ISLAND, THE DESIGNER, AND THE PLANT CONTRACTOR TO DISCUSS THE PROJECT AND THE PLANTING SCHEDULE.
- ALL PLANTING SHALL BE COMPLETED BY THE END OF THE GROWING SEASON (OCTOBER 15). PLANTING SHALL BE COMPLETED BY THE END OF THE GROWING SEASON (OCTOBER 15).
- SET CONSTRUCTION MARKS BASED ON PERSONS AS SHOWN ON THE DRAWINGS. THE CONSTRUCTION CONTRACTOR SHALL ACCOMMODATE REALIZED AND ANTICIPATED SITE CONDITIONS WHEN CONSIDERING THE PLANTING SCHEDULE.

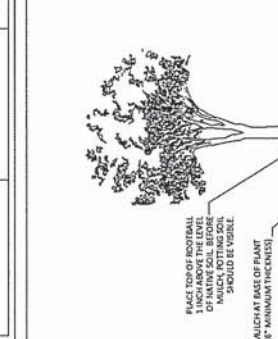

Tree Installation Details
NOT TO SCALE

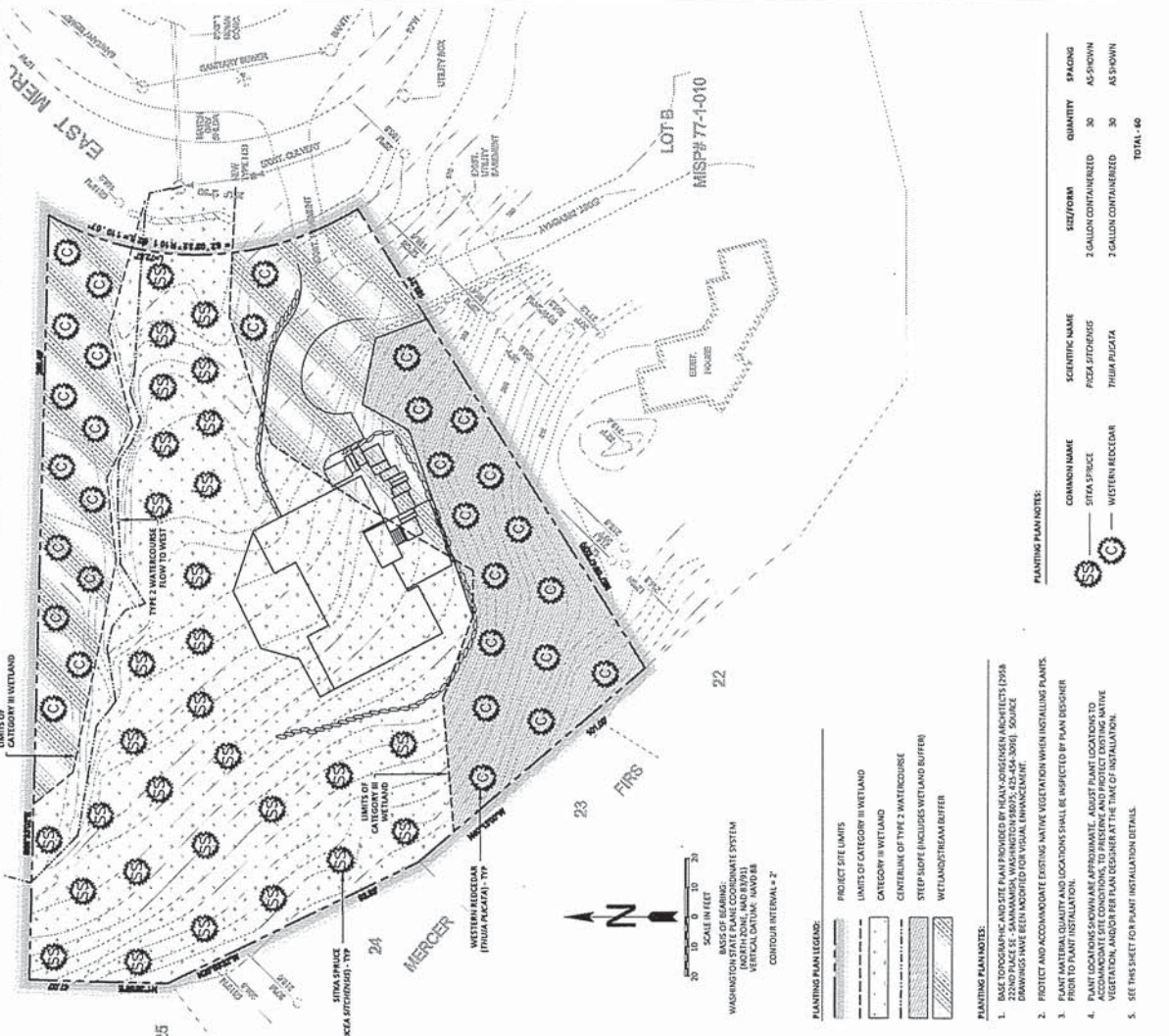

PLANTING PLAN NOTES:

- BASE TOPOGRAPHIC AND SITE PLAN PROVIDED BY HEAN-JONGSEOK ARCHITECTS (2014). THE PLANTING PLAN IS A DESIGN CONCEPT AND SHOULD BE USED AS A GUIDE ONLY. SOURCE DRAWINGS HAVE BEEN ACCREDITED FOR VISUAL IMPACT ANALYSIS.
- PROTECT AND ACCOMMODATE EXISTING NATIVE VEGETATION WHEN INSTALLING PLANTS.
- PLANT MATERIAL QUALITY AND LOCATIONS SHALL BE INSPECTED BY PLANT DESIGNER PRIOR TO PLANT INSTALLATION.
- PLANT LOCATIONS SHOWN ARE APPROXIMATE. ADJUST PLANT LOCATIONS TO FIT VEGETATION, AND/OR PER PLAN DESIGNER AT THE TIME OF INSTALLATION.
- SEE THIS SHEET FOOT-PRINT PLANT INSTALLATION DETAILS.